



Eveready Battery Company, Inc.

Checkerboard Square  
 St. Louis, MO 63164  
 Telephone 1-800-383-7323  
 Internet: www.energizer.com

## Engineering Data

**Zinc Chloride 12V  
 Classic**  
 No Added Mercury or Cadmium

### EVEREADY NO. 732

Dimensions (mm)

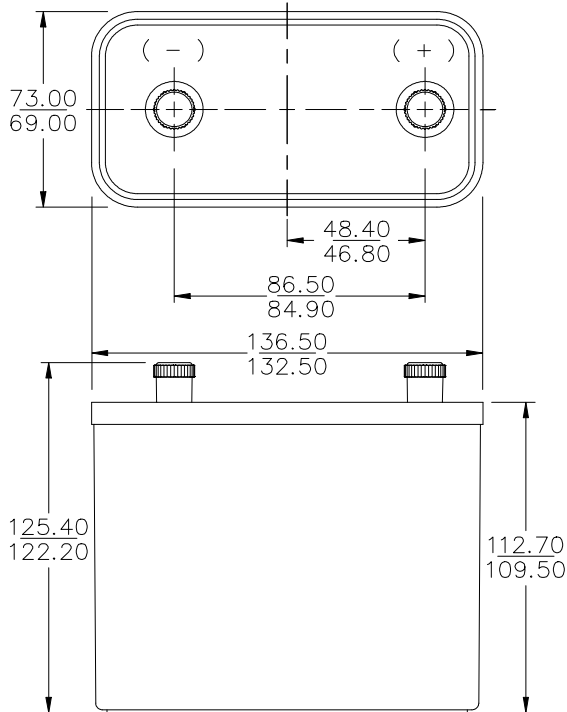

**Chemical System:** Zinc-Manganese Dioxide (Zn/MnO<sub>2</sub>)  
**Designation:** ANSI-926, IEC-8R25  
**Battery Voltage:** 12 Volts  
**Average Weight:** 1.2 kilograms (42.5 oz.)  
**Volume:** 1182 cubic centimeters (72 cubic inch)  
**Average Service capacity (to 6.0 Volts / cell):** 7.5 Ah  
 (Rated capacity at 25 mA continuous drain)  
**Cell:** Eight No. 60 (size "F") in series  
**Terminals:** Insulated Knurl / Screw Post  
**Jacket:** Plastic

Millimeters	Inches
46.80	1.843
48.40	1.906
69.00	2.717
73.00	2.874
84.90	3.343
86.50	3.406
109.50	4.311
112.70	4.437
122.20	4.811
125.40	4.937
132.50	5.217
136.50	5.374

**CONSTANT RESISTANCE PERFORMANCE**  
 Typical Service

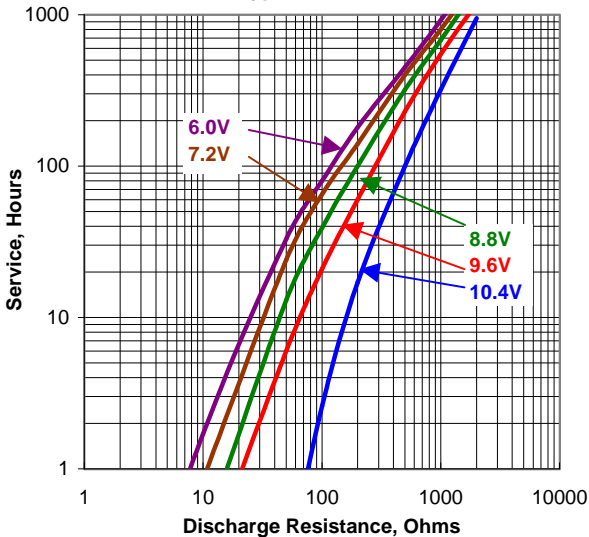

**CONSTANT CURRENT PERFORMANCE**  
 Typical Service

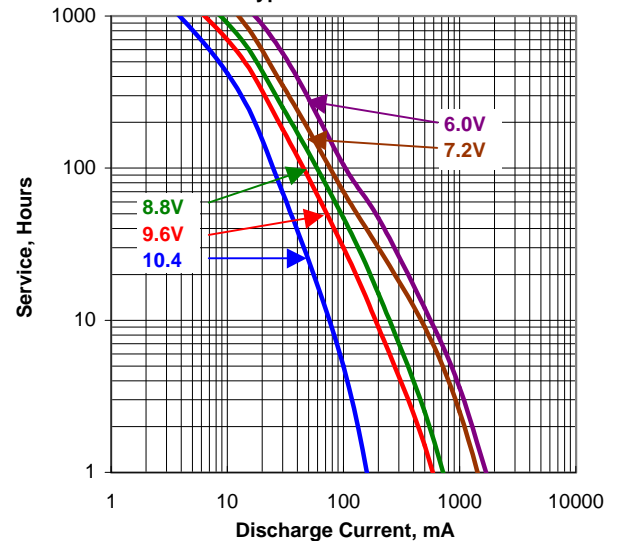

## Typical Applications

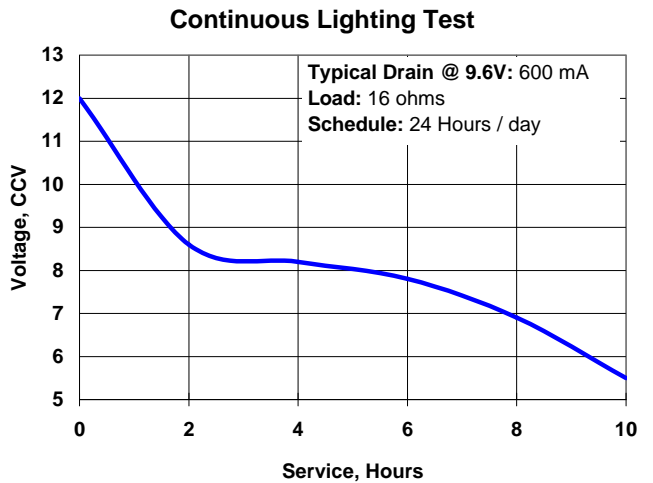
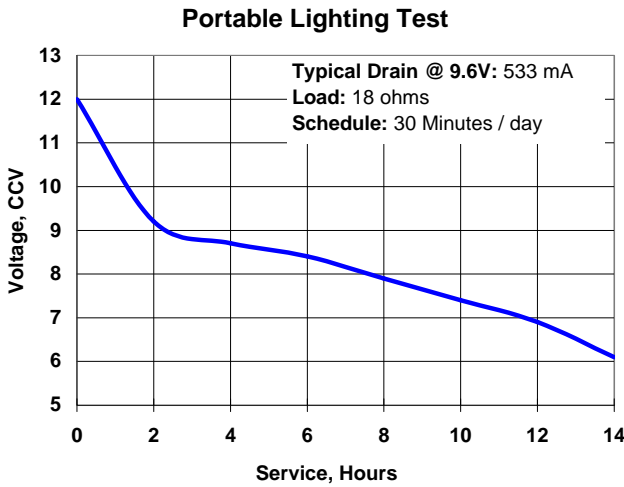
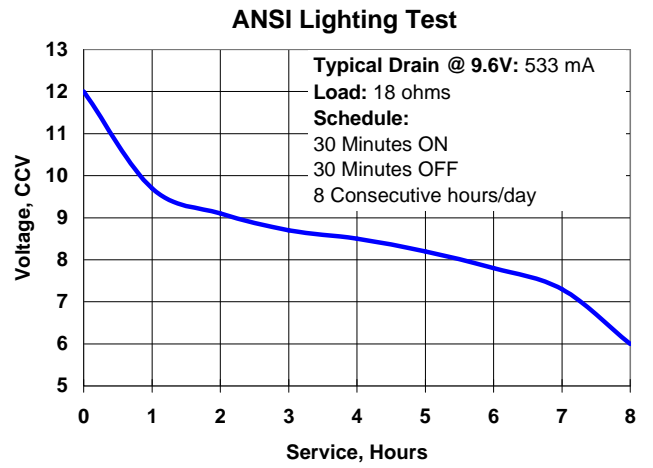
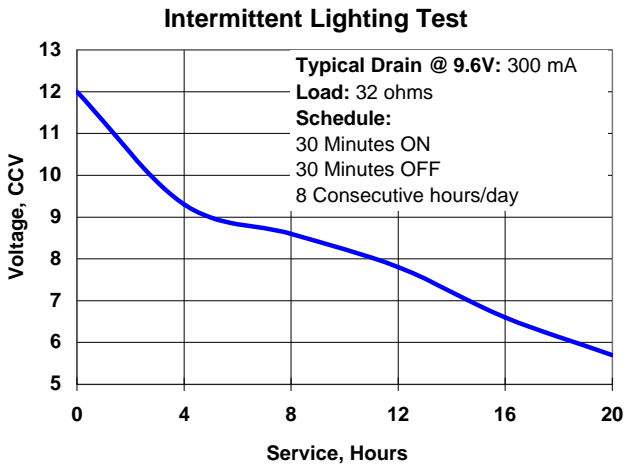

#### INTERNAL RESISTANCE VS. TEMPERATURE

This measurement is an approximation of the battery's actual internal resistance. It is sensitive to the loads and operator technique.

**Schedule:** Background Load 600 ohms.  
 Pulse Load 10 ohms.  
 Pulse Duration 1 second

Temperature	Typical Ri (ohms)
45°C (113°F)	2
21°C (70°F)	2.1
0°C (32°F)	2.4
-21°C (-4°F)	24

#### Important Notice

This data sheet contains information specific to batteries manufactured at time of its publication. Please contact your Energizer representative for most current information. Contents herein do not constitute a warranty.